



300 Rodd Street, Suite 201 • Midland, MI 48640
 989-839-0340 • fax 989.839.7372 • info@midlandtomorrow.org

Eastwick Industrial Park, established in 1988, is a Michigan Certified Industrial Park consisting of 85 acres of wooded parcels averaging 4.5 acres. Eastwick is conveniently located off the Waldo Avenue exit of the US-10B/M-20 interchange less than one mile from Eagle Ridge Technology Park and near other industrial sites on the southeast side of Midland, Michigan. It is between the global headquarters of The Dow Chemical Company and Dow Corning Corporation. Companies located in Eastwick Industrial Park include Brady News and Recycling, Caltech Industries, Central Warehouse Co., Dendritech, Inc., Dollar Daze, Inc., Greif Corporation, Precision Torque Control, Prime Industrial Fasteners, QuadSil, Inc., The Safety Equipment Store, and Siemens Building Technologies.

"Eastwick is an ideal location for an industrial park. It's near an onramp to a major expressway (US-10), but, at the same time, in a low traffic area so it's easy for trucks to get in and out. A big plus is the quiet, pastoral setting, making Eastwick a pleasant place to visit as well as work."

John Strobel
 President and CEO
 Central Warehouse Co.

Location:	Schuette Road and Waldo Avenue
Shape/Size:	Flat/Rectangular
Flood Plain:	No
Zoning:	Industrial B – Certified Industrial Park
Electric:	Consumers Energy – 3 Phase/480 Volt
Water:	City of Midland – 16" Main
Sewer:	City of Midland – 10" Main
Gas:	Consumers Energy – 6" High-Pressure Steel Gas Main with 300+ PSI
High Speed Wireless Internet Access:	192K, 384K, 768K, 1.1M, 1.5M. http://www.mercury.net/business/wireless/ for more information
Railroad:	CSX Transportation
Tax Rate:	Non-homestead 47.2338/\$1,000 (2004)

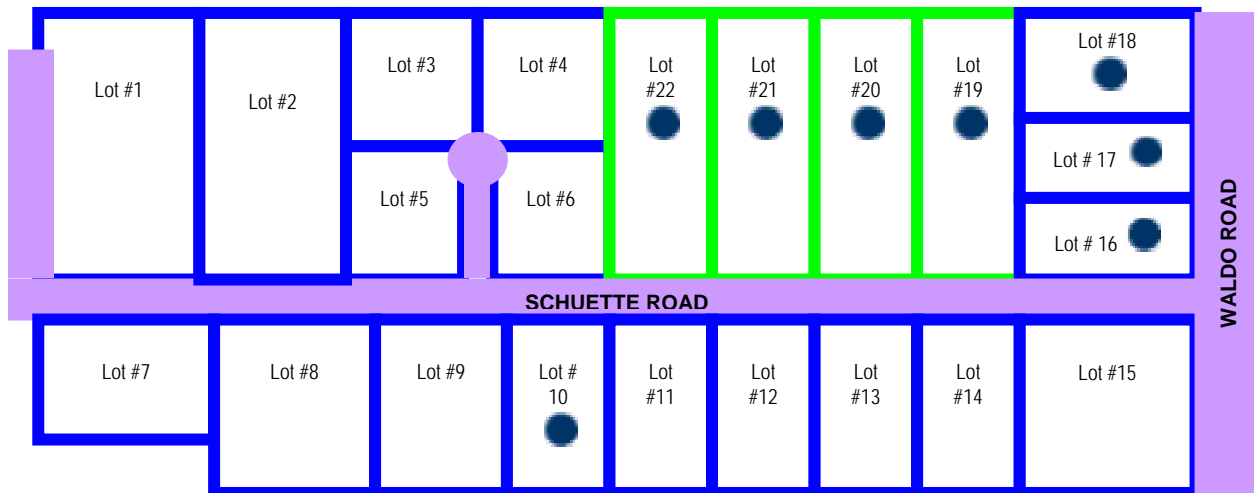

● indicate available lots

- | | |
|---|---|
| 1. Prime Industrial Fasteners | 10. Available (4.76 acres • 410.50' x 505.00') |
| 2. BWP Transport | 11/12. Dollar Daze, Inc. |
| 3. QuadSil, Inc. | 13/14. Dendritech, Inc. |
| 4. Precision Torque Control | 15. Brady News and Recycling |
| 5. Mitch Art & Design | 16. Available(2.20 acres • 230.15' x 417.24') |
| 6. Available (Contact Keller Williams Realty, 734-266-9000) | 17. Available (1.92 acres • 200.00' x 417.24') |
| 7. Caltech Industries | 18. Available (2.87 acres • 299.38' x 417.24') |
| 8a. Available (Contact Central Warehouseco., 989-496-0800) | 19. Available (4.54 acres • 270.99' x 729.68') |
| 8b. The Safety Equipment Store | 20. Available (3.77 acres • 225.00' x 729.81') |
| 8c. Siemens Building Technologies | 21. Available (3.35 acres • 200.00' x 723.02') |
| 9a. GREIF Corporation | 22. Available (3.10 acres • 187.00' x 724.91') |
| 9b. Central Warehouse Co. | |